



Bay Settlement and Van Lanen Road Reconstruction

February 25, 2021

Virtual Meeting

- All attendees have been muted
- If you have a question you can type it in the chat area
- If you are not able to ask a question please contact me by phone or email after the meeting
- If you are calling in and not on a computer you will not be able to see some of the visuals displayed during the presentation

What is the Project

- Reconstruction of Bay Settlement Road from just south of Bay Settlement Court to just north of Van Lanen Road
- Reconditioning of Van Lanen Road from the Green Bay City limits to Bay Settlement Road

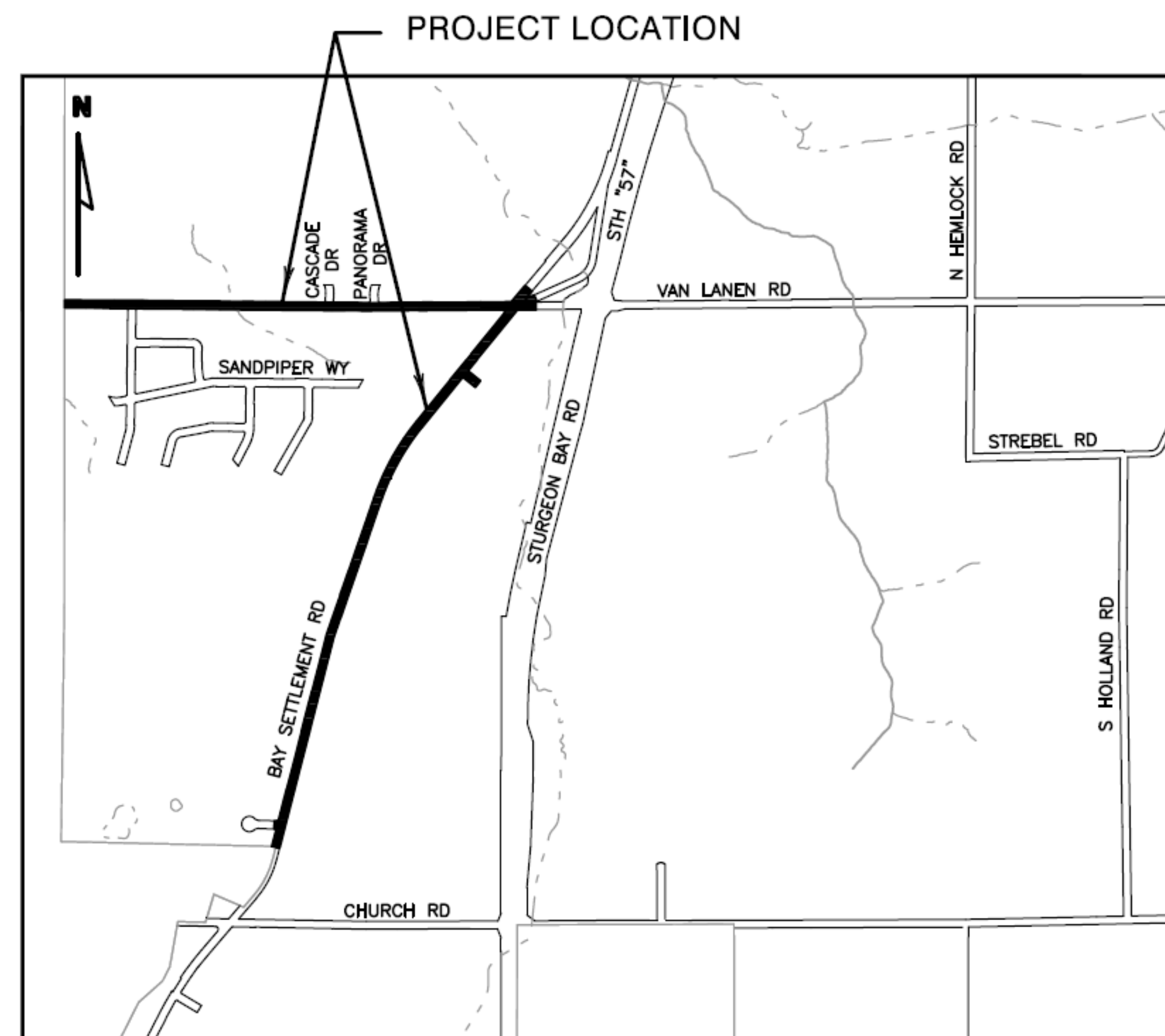

Bay Settlement Road

- Urbanization of the existing roadway
- No assessments for roadway
- Same section as Bay Settlement Road to the south
 - 11-foot travel lanes
 - 4-foot bike lanes
 - Curb and gutter
 - No parking on road



Bay Settlement Road

- Storm sewer will require rock removal by either blasting or rock trenching (this will be determined by the contractor)
- Blaster will be required to offer structure survey to all structures along Bay Settlement Road prior to blasting
- Blasting will be monitored per state statues
- Sanitary Sewer and water laterals will be installed to vacant lots that could develop in the future (the Town is working with those property owners that this affects)
- Storm sewer laterals can be installed if requested by the property owner from the main to the right-of-way, owner required to connect from ROW to home (owner shall hook-up to lateral within a year)

Bay Settlement Road

- The road will be closed to through traffic
- During storm sewer construction and blasting you will not be able to get past where they are working
- After hours contractor will provide for one lane to pass working area
- There will be periods of time you will not be able to get into your driveway
- Mailboxes will be removed by the contractor and placed in your lawn
- It will be property owner's responsibility to re-install mailboxes after construction is completed
- Temporary mailboxes will be set up on the south end of Bay Settlement Road just south of the construction limits

Van Lanen Road

- Existing pavement and base will be removed and the road lowered about 0.5 -1 foot
- New base course and pavement will be added
- 11-foot driving lanes
- 3-foot paved shoulders
- Driveway culverts will not be replaced
- Two cross culverts will be replaced



Van Lanen Road

- No blasting on this section of the project
- Roadway will be closed to through traffic
- During culvert replacements you will not be able to get through that point
- Mailboxes will be removed by the contractor and placed in your lawn
- It will be property owner's responsibility to re-install mailboxes
- Temporary mailboxes will be set up on Bay Heights Drive for Van Lanen Road residents
- Driveways will be cut back 6-10 feet to match in with new roadway. The section cut out will be replaced with asphalt pavement

Project Schedule

- Project is expected to start in May or June and completed by October 1, 2021
- Bay Settlement Road will begin first with Van Lanen being done later in the summer (this may change depending on contractor)
- Once a contractor is awarded the project there will be a meeting with the contractor and residents to discuss the project
- Updates of project will be posted on the Town web site



Questions

If you are unable to ask a question please contact Scott Brosteau at (920) 593-6860 or email at scott.brosteau@meadhunt.com